

# Sectional Rail Coupling I Type PKV

vertical linear coupling for automatic or manual clamping

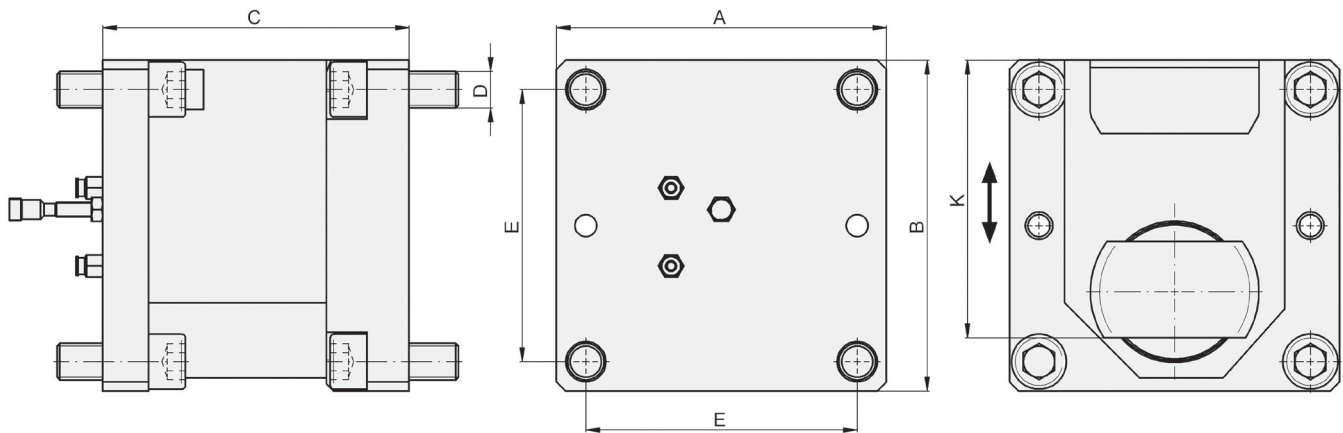

Technical data and dimensions [mm]: measure of length according to DIN ISO 2768 mH

Type	*operating forces				**bending	TA	weight	couple	compen-		dimensions [mm]				
	FB [kN]	FBmin [kN]	FR [kN]	FRmin [kN]	moment [Nm]	(PKV-M) [Nm]	[kg]	distance K	hor.	ver.	width A	height B	length C	bore pattern D	E
PKV-M-80x80	20	-	25	-	1000	20	2,5	71	1,5	1,5	80	80	75	4x M8	66
PKV-P-80x80	12,5(18)	3	20(30)	4,5	1000	-	2,6	71	1,5	1,5	80	80	80	4x M8	66
PKV-M-100x100	30	-	35	-	2000	25	4,8	91	2,5	2	100	100	91	4x M10	82
PKV-P-100x100	20(27)	4	30(40)	6	2000	-	4,8	89	2,5	2	100	100	95	4x M10	82
PKV-M-120x120	40	-	60	-	3000	30	8	105	2	2	120	120	109	4x M12	100
PKV-P-120x120	30(45)	6,5	50(70)	10,5	3000	-	8,7	105	2,5	2	120	120	120	4x M12	100
PKV-M-140x140	60	-	80	-	6500	35	12	122	2,5	2,5	140	140	120	4x M14	115
PKV-P-140x140	40(60)	8,5	65(90)	14	6500	-	12	122	3	2,5	140	140	134	4x M14	115
PKV-M-160x160	70	-	100	-	7500	40	18	135	3	2,5	160	160	137	4x M16	132
PKV-P-160x160	50(75)	11	80(120)	17,5	7500	-	18	135	3	2,5	160	160	145	4x M16	132
PKV-M-180x180	80	-	130	-	13000	50	25	154	4	3	180	180	152	4x M20	148
PKV-P-180x180	60(95)	17	100(150)	28	13000	-	26	154	4	3	180	180	164	4x M20	148
PKV-M-200x200	80	-	130	-	15000	50	29	168	4	3	200	200	164	4x M20	168
PKV-P-200x200	75(115)	17	125(190)	28	15000	-	35	168	5	3,5	200	200	184	4x M20	168

\*FB - tolerable axial operating force at nominal pressure PN = 6 bar (10 bar)

FBmin - minimal operating force at no pressure P = 0 bar

FR - tolerable vertical locking force at PN = 6 bar (10 bar)

FRmin - minimal locking force at no pressure P = 0 bar

\*\*tolerable operating values M x / y / z at nominal pressure PN = 6 bar

materials: tempered steel - nitrated

**Note:** version with customer-specific energy coupling for supplying the changing rail with power, air booster (does not belong to the scale of delivery) for 10 bar operating pressure or different sectional profiles (A x B) on demand.

manual clamping with operating hex head - top view:  
TA operation torque for version „M“

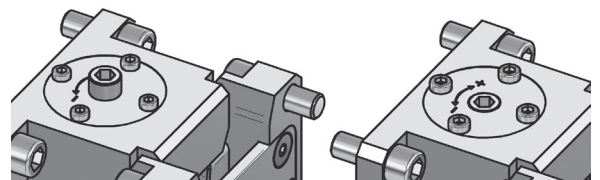

release position

clamping position

order example:

sectional rail coupling

PKV - P - 140 x 140 - active part

„P“ - automatic clamping (pneumatic) / „M“ - manual clamping \_\_\_\_\_

Size 140 x 140 - sectional profile \_\_\_\_\_

active part / passive part \_\_\_\_\_