

# Metal Bellows Coupling I Series KM

6-corrugation bellows simple installation with lateral EASY-clamping hub low-cost standard series

technical data:

| KM size | TN [Nm] | moment of inertia [10 <sup>-3</sup> kgm <sup>2</sup> ] | torsional stiffness [Nm/arcmin] | max. shaft misalignment (mm) |         | axial spring rate [N/mm] | lateral spring rate [N/mm] | tightening torque of screws [Nm] | nmax. [rpm] |
|---------|---------|--|---------------------------------|------------------------------|---------|--------------------------|----------------------------|----------------------------------|-------------|
|         |         |  |                                 | axial±                       | lateral |                          |                            |                                  |             |
| 20      | 20      | 0,14   | 5,2                             | 0,8                          | 0,25    | 51                       | 190                        | 14                               | 20000       |
| 35      | 35      | 0,14   | 5,8                             | 0,8                          | 0,25    | 51                       | 190                        | 14                               | 20000       |
| 60      | 60      | 0,29   | 8,7                             | 0,9                          | 0,3     | 49                       | 260                        | 30                               | 17000       |
| 80      | 80      | 0,79   | 14                              | 1                            | 0,3     | 45                       | 280                        | 50                               | 14000       |
| 170     | 170     | 0,83   | 17                              | 1                            | 0,3     | 80                       | 470                        | 50                               | 14000       |
| 270     | 270     | 2,2  | 32                              | 1                            | 0,3     | 70                       | 450                        | 90                               | 11000       |
| 400     | 400     | 2,4  | 47                              | 1                            | 0,3     | 100                      | 640                        | 90                               | 11000       |
| 600     | 600     | 5,3  | 67                              | 1                            | 0,3     | 100                      | 980                        | 140                              | 9000        |
| 900     | 900     | 9  | 105                             | 1                            | 0,3     | 145                      | 1000                       | 180                              | 8500        |
| 1300    | 1300    | 14   | 170                             | 1                            | 0,3     | 130                      | 920                        | 240                              | 7000        |

smaller couplings from 0,4 Nm - 12 Nm see series MKM

temperature range: -40°C up to +200°C

material:

hubs: high-tensile strength aluminum

screws: ISO 4762 / 12.9

bellows: stainless steel

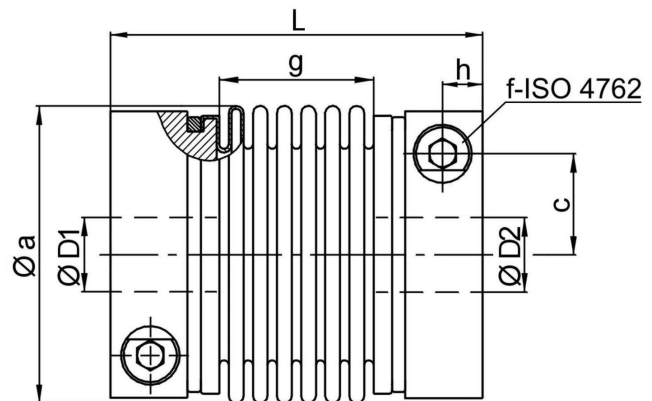

Dimensions [mm]: length dimensions according to DIN ISO 2768 cH

| KM   | Øa  | c    | f    | g  | h    | L   | L*  | mass ~ [kg] | ØD1/2 min | ØD1/2 max |
|------|-----|------|------|----|------|-----|-----|-------------|-----------|-----------|
| 20   | 56  | 19   | M 6  | 30 | 8    | 70  | 81  | 0,3         | 8         | 32        |
| 35   | 56  | 19   | M 6  | 30 | 8    | 70  | 81  | 0,3         | 10        | 32        |
| 60   | 66  | 22   | M 8  | 33 | 9    | 77  | 87  | 0,5         | 13        | 35        |
| 80   | 82  | 28,5 | M 10 | 38 | 11,5 | 90  | 102 | 0,8         | 16        | 43        |
| 170  | 82  | 28,5 | M 10 | 40 | 11,5 | 92  | 104 | 0,8         | 18        | 43        |
| 270  | 101 | 35   | M 12 | 42 | 13   | 100 | 106 | 1,4         | 25        | 55        |
| 400  | 101 | 35   | M 12 | 48 | 13   | 106 | 112 | 1,5         | 30        | 55        |
| 600  | 122 | 42   | M 14 | 52 | 16   | 120 | -   | 2,4         | 32        | 68        |
| 900  | 133 | 47   | M 14 | 53 | 18,5 | 143 | -   | 3,5         | 40        | 75        |
| 1300 | 157 | 54   | M 16 | 55 | 20   | 145 | -   | 4,2         | 48        | 85        |

note: L\* ≙ variable length with bigger clamping hub size (see order example)

· version with steel hub and plasma welded joint, as well as higher torques see series „KG“

order example: KM 170 - D1 = 30 G<sup>7</sup> D2 = 35 H<sup>6</sup>  
KM 170 | 104 - D1 = 28 G<sup>6</sup> D2 = 42 G<sup>6</sup>