

Metal Bellows Coupling with intermediate Pipe I WD-VA-Ex

- backlash free, exact torque transfer • variable length up to 3 m
- very easy to fit with splitted hub design

stainless steel



technical data:

WD-VA-Ex size	T _N [Nm]	moment of inertia [10 ⁻³ kgm ²]				torsional stiffness [Nm/arcmin]				mass [kg]				max. speed approx. [1/min]			
		0,5m	1m	2m	3m	0,5m	1m	2m	3m	0,5m	1m	2m	3m	0,5m	1m	2m	3m
10	5	0,07	0,09	0,13	0,17	0,22	0,11	0,06	0,04	0,8	1,2	2,2	3,1	6000	1550	350	150
50	25	0,63	0,81	1,18	1,55	1,6	0,88	0,46	0,31	1,9	2,9	5	7	6000	3400	740	310
120	60	2,1	2,5	3,2	3,9	3,7	2	1	0,7	3,3	4,6	7,3	9,9	6000	4700	1000	400
200	100	3,9	4,5	5,7	6,9	5,7	3	1,5	1	4,7	6,5	10	13	6000	5500	1100	470
350	175	8,4	9,3	11	13	9,7	4,8	2,4	1,6	8,4	9,3	12,3	16	6000	6000	1300	550
600	300	29	22	26	30	22	11	5,3	3,5	11,5	14	19	24	6000	6000	1700	700
1200	600	66	74	89	104	66	36	19	13	21	25	33	42	6000	6000	2650	1050

maximum axial shaft misalignment: $\Delta A = \pm 1 \text{ mm}$ / maximum angular shaft misalignment: $\alpha = 0,7^\circ$

maximum lateral shaft misalignment: $\Delta R = \tan \alpha \cdot L_x$ mit $L_x = L - (2 \cdot k) / \tan \alpha$

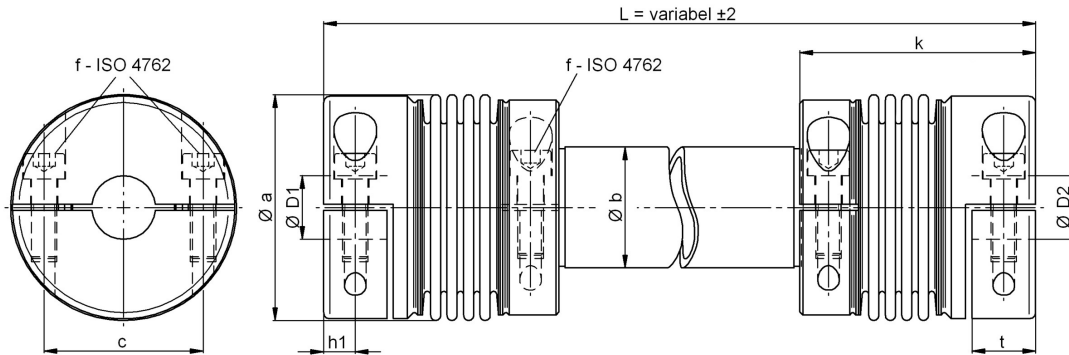

material specifications: hub: 1.4301, tube: AISI 304 (A2) or AISI 316 (A4), bellows: 1.4571, screw: A4-80
 maximum permissible temperature range: -20° celsius to +100° celsius

note: bellows and hubs are joined using micro-plasma welding.

The couplings are supplied with H7 finished bores as standard.
 G6 is recommended for the shaft fit.

dimensions [mm]: length dimensions according to DIN ISO 2768 cH

WD-VA-Ex size	Øa	Øb	c	f-T _A	h	k	t	L _{min}	ØD1/2 min	ØD1/2 max
10	36	16	21	M5 - 5	6,5	46	13	92	9,1	15
50	60	30	28	M8 - 24	9	63	17	126	15,6	28
120	76	38	38	M10 - 45	12	77	23	154	24,7	38
200	82	42	56	M12 - 80	13	86,5	25,5	173	28,6	42
350	101	48	68	M14 - 110	15	97	30	194	39	50
600	122	60	80	M12 - 180	18	115	36	230	41,6	60
1200	157	89	110	M16 - 350	20	128	40	256	62,4	85

*Øa: interfering edge - screw head

- clamping hubs generally with stainless steel screws A4/80 without EASY pin.
- larger lengths up to 6m and higher operating speeds available on request.

order example: WD - VA -Ex 200 D1 = 32^{H7} D2 = 35^{H7} L = 800