

1 : 2

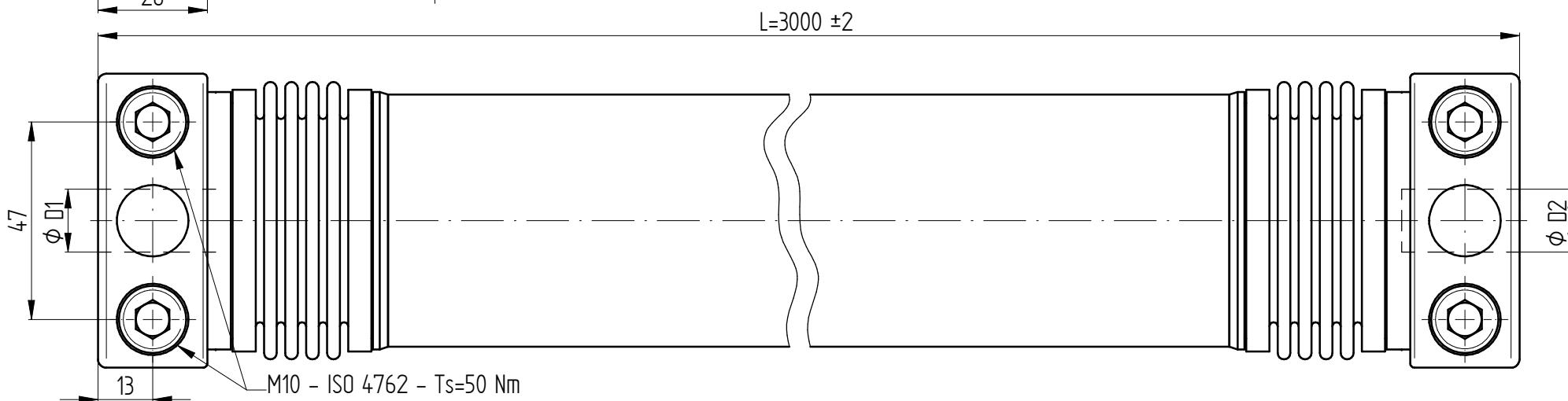

technical data:

| | | |
|---------------------------------|----------------|-----------------------------------|
| nominal torque: | 100 | Nm |
| maximum torque: | 200 | Nm |
| torsional stiffness: | 1,0 | Nm/arcmin |
| max. radial shaft displacement: | 50 | mm |
| max. axial shaft displacement: | ± 1,5 | mm |
| mass: | 5,5 | kg |
| moment of inertia: | 4,1 | 10 ⁻³ kgm ² |
| max. speed: | 670 | min ⁻¹ |
| D1 - D2 min/max: | 12,5/35 | mm |
| temperature range: | -40 up to +200 | °C |

material:

bellows: stainless steel 1.4571
hubs: high-tensile strength aluminium
intermediate pipe: high-tensile strength aluminium

| | | | | | | |
|---------------|--------------------|-------|----------|---|-----------------|-----------------|
| | | | | Werkstoffbezeichnung | Werkstoffnummer | Maßstab |
| | | | | - | - | 1:1 |
| | | | | Rohteil-/Vorteilnummer | Gewicht | |
| | | | | - | - kg | |
| | | | | Metal Bellows Coupling with Intermediate Pipe | | |
| | | | | WDS 100 - L=3m | | |
| Passung | Abmaß | gez. | 15.05.17 | Be | Benennung | Format A3 |
| DIN ISO 13715 | DIN ISO 2768-mK | Datum | Name | Benennung | Artikelnummer | |
| -0,4 | 0,5 ... 6 ± 0,1 | | | | | |
| +0,8 | 6 ... 30 ± 0,2 | | | | | |
| | 30 ... 120 ± 0,3 | | | | | |
| | 120 ... 315 ± 0,5 | | | | | |
| | 315 ... 1000 ± 0,8 | | | | | |
| | | | | Ersatz für | - | ersetzt durch - |

JAKOB
Antriebstechnik

D-63839-Kleinwallstadt