

Sectional Rail Coupling I Type PKH-P

horizontal linear coupling for automatic clamping

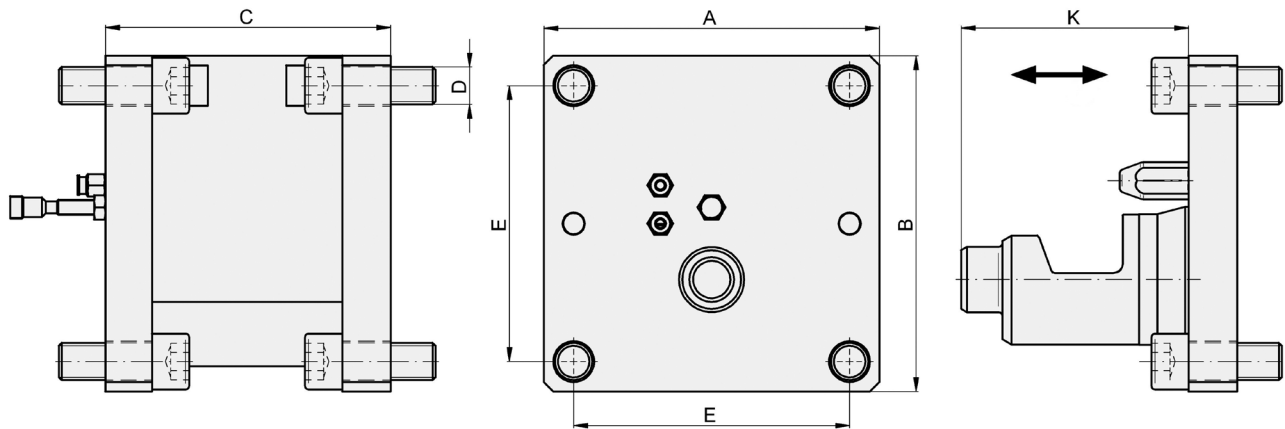

Technical data and dimensions [mm]: measure of length according to DIN ISO 2768 mH

Bezeichnung	*operating forces			**bending		couple distance K	compen- sation horiz.	Abmessungen [mm]				
	FB [kN]	FBmin [kN]	FQ [kN]	moment [Nm]	weight [kg]			width A	height B	length C	bore pattern D	E
PKH-P 80x80	12,5(19)	3	25	1000	2,9	53	3	80	80	80	4x M8	66
PKH-P 100x100	18(26)	4	35	2000	5,0	64	4	100	100	93	4x M10	82
PKH-P 120x120	30(45)	6,5	60	3000	8,7	82	4,5	120	120	115	4x M12	100
PKH-P 140x140	40(60)	10	70	6500	12,7	88	5	140	140	128	4x M14	115
PKH-P 160x160	50(75)	11,5	100	7500	18,6	109	5	160	160	140	4x M16	132
PKH-P 180x180	60(90)	14	150	13000	26,5	108	6	180	180	156	4x M20	148
PKH-P 200x200	80(115)	18,5	150	15000	34,7	126	7	200	200	173	4x M20	168

*FB - tolerable axial operating force at nominal pressure PN = 6 bar (10 bar)

FBmin - minimal operating force at no pressure P = 0 bar

FQ - tolerable vertical operating force (pressure-independent)

**tolerable operating values M x / y / z at nominal pressure PN = 6 bar

materials: tempered steel - nitrated

Note: version with customer-specific energy coupling for supplying the changing rail with power, air booster (does not belong to the scale of delivery) for 10 bar operating pressure or different sectional profiles (A x B) on demand.

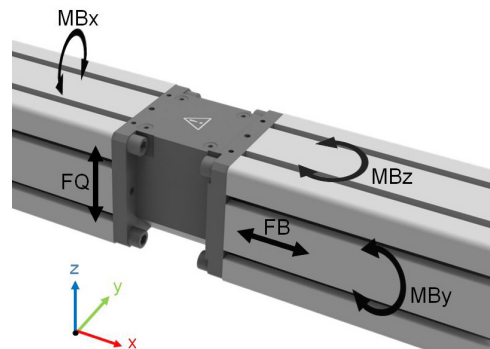

order example:

sectional rail coupling

PKH - P - 140 x 140 - active part

Type PKH-P - automatic clamping (pneumatic) / _____

Size 140 x 140 - sectional profile _____

active part / passive part _____